

PROPRIETARY AND CONFIDENTIAL

THE INFORMATION CONTAINED IN THIS DRAWING IS THE SOLE PROPERTY OF DYTRAN INSTRUMENTS INC. ANY REPRODUCTION IN PART OR AS A WHOLE WITHOUT THE WRITTEN PERMISSION OF DYTRAN INSTRUMENTS INC. IS PROHIBITED

REVISIONS

REV	ECN	DESCRIPTION	BY/DATE	CHK	APPR
A	14697	INITIAL RELEASE, SAME AS X1	DP 11/13/18	KG	W

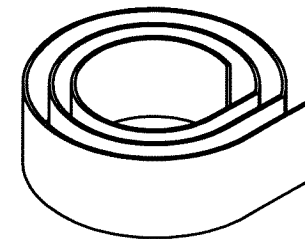
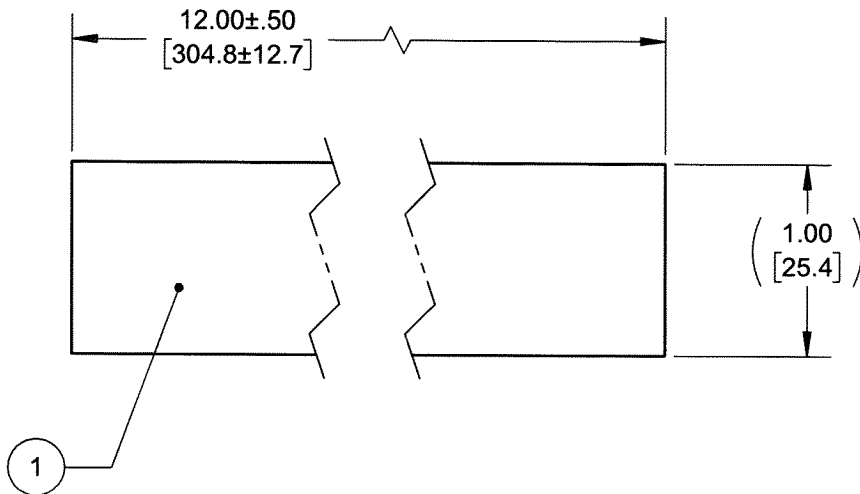

3. TEMPERATURE RESISTANCE:

CONTINUOUS EXPOSURE: 175°F (79°C)
 INTERMITTENT EXPOSURE (30 MIN.): 250°F (121°C)

2. TYPICAL LUMINANCE FACTOR:

4° READING: 900X
 SKEWED 45° READING: 700X

1. THICKNESS: - APPLIED: .004" (.010cm) -
 - LINER: .006" (.015cm)

USED ON	NEXT ASSY

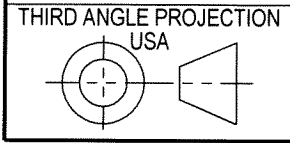

UNLESS OTHERWISE SPECIFIED:
 INTERPRET DIM & TOL PER ASME Y14.5M - 1994.
 REMOVE BURRS.
 COUNTERSINK INTERNAL THDS 90° TO MAJOR DIA.
 CHAM EXT THDS 45° TO MINOR DIA.
 THD LENGTHS AND DEPTHS ARE FOR MIN FULL THDS.
 THDS PER MIL-S-7742.
 DIMENSIONS APPLY AFTER FINISHING.

ALL MACHINED SURFACES. ⁶³
 TOTAL RUNOUT WITHIN .005.
 BREAK SHARP EDGES .005 TO .010.
 MACHINED FILLET RADII .005 TO .015.
 WELDING SYMBOLS PER AWS A2.4.
 ABBREVIATIONS PER MIL-STD-12.

UNLESS OTHERWISE SPECIFIED:
 DIMENSIONS ARE IN INCHES.
 DIMENSIONS IN BRACKETS [] ARE IN MILLIMETERS
 TOLERANCES ARE:
 INCHES METRIC ANGLES
 .XX ± .03 .X ± 0.8 ± 1°
 .XXX ± 0.10 .XX ± 0.25

MATERIAL	
FINISH	
DO NOT SCALE DRAWING	

CONTRACT NO.		
APPROVALS		DATE
ORIG	LN	01/24/17
CHK	KG	11/13/18
APP	W	11/14/18
APP		



MASTER COPY ONLY IF IN RED
 Chatsworth, CA

TITLE: **OUTLINE/INSTALLATION DWG, HIGH GAIN REFLECTIVE TAPE- 1.0" WIDE X 12" LONG, 69002**

SIZE	CAGE CODE	DWG. NO.	REV
A	2W033	127-69002	A

SCALE: NONE SOLIDWORKS SHEET 1 OF 1