



应用概述

电阻点焊是一种通过电阻发热，使得金属升温发生溶化，上下两电极施压，金属间结合一起的过程。这个过程中，电极施加的力很关键，不正确的施加大小，会引起裂缝、洞和焊接失败。FUTEK 的 LLB300 微型测力传感器，会帮助操作者在这个过程当中，正确地控制力的大小。

使用产品

微型按钮测力传感器（LLB 系列），与相关的仪器仪表 IHH500、IPM650、USB 采集模块及 SENSIT 软件。

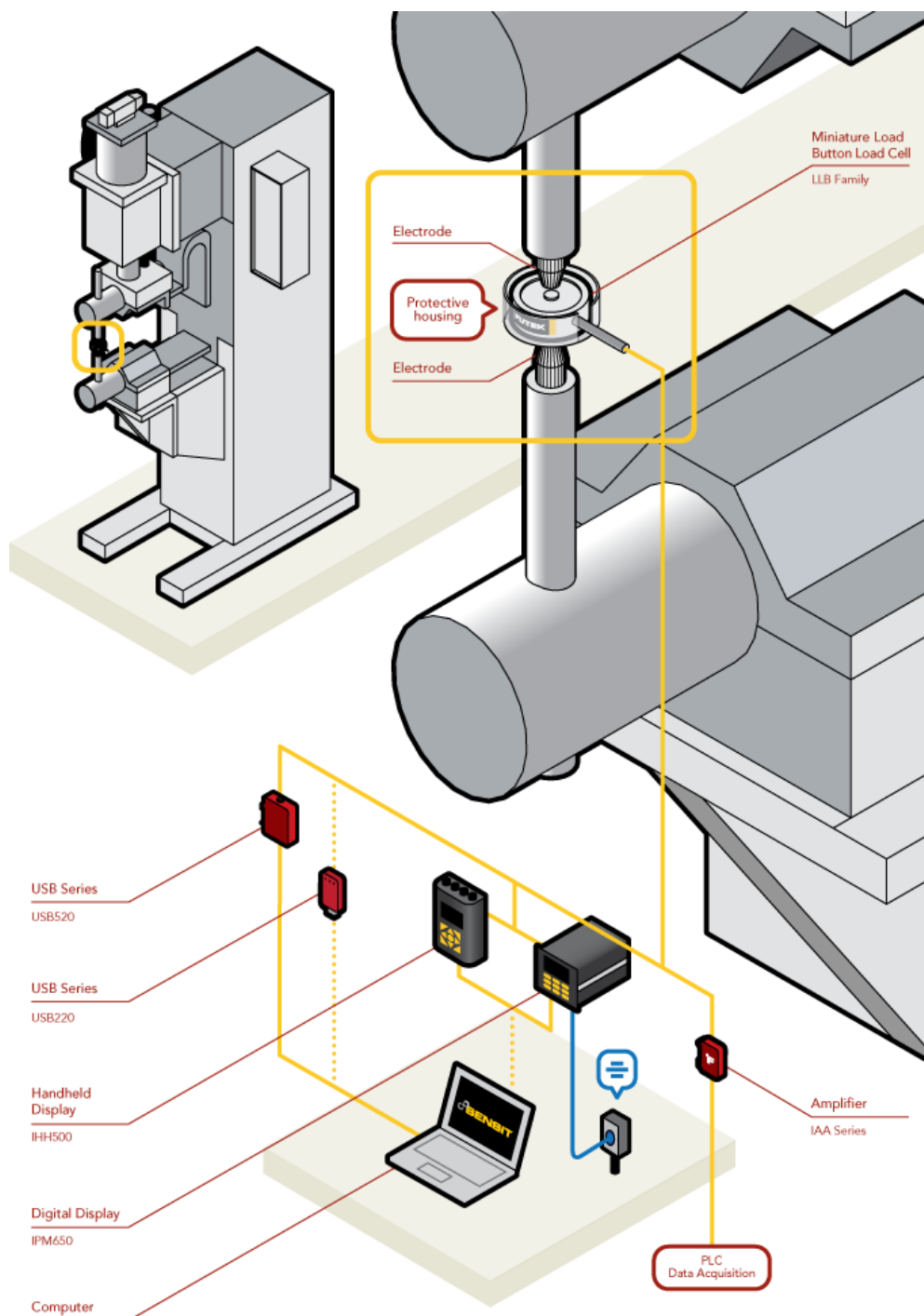

测力传感器

Sensor Solution Source

Load · Torque · Pressure · Multi Axis · Calibration · Instruments · Software

www.omgl.com.cn | sales@omgl.com.cn





使用说明

1. Resistance Spot Welding is commonly used in the automotive industry for vehicle body parts.
2. Resistance Welding machines must apply a specific amount of pressing force with the electrodes in order to ensure that the machine will apply a proper weld..
3. Load Cells can be used to measure the pressing force of a Resistance Spot Welding machine.
4. In this application, FUTEK's LLB300 Miniature Load Button is placed between the electrodes to calibrate the force applied. As force is applied by the machine, the LLB300 will sense the load measurement and can display the value on FUTEK's IHH500 Intelligent Digital Hand Held display, FUTEK's IPM650 Panel Mount Display, or a PC via FUTEK's USB Solutions.
5. Pairing the SENSIT™ Test and Measurement Software with any of FUTEK's instruments provides the user with the ability to data log and live graph the measurements and store them for calibration history.
6. NOTE: We recommend engineers use caution upon installation of the load cell between the electrodes, so as not to damage the LLB's housing.



LLB 系列

微型按钮型力传感器



USB220

数据采集模块



USB520

应变动态扭力 USB 采集模块



IHH500

便携式显示仪表



IPM650

面板式显示仪表



IAA 系列

应变式放大器

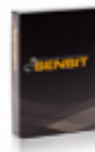

软件

SENSIT™ Test and Measurement